

PIN NO.	PIN NAME
C1	VCC
C2	RST
C3	CLK
C5	GND
C6	VPP
C7	I/O
S/W	Switch Pin

RECOMMENDED PCB LAYOUT
 TOLERANCE ±0.05
 SMT SOLDER AREA

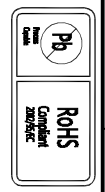
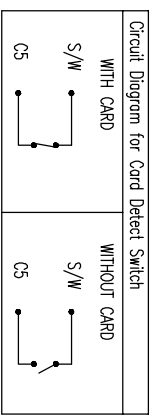
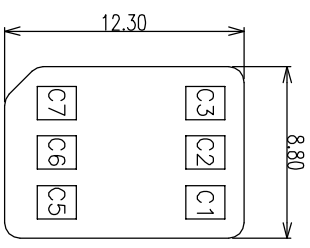
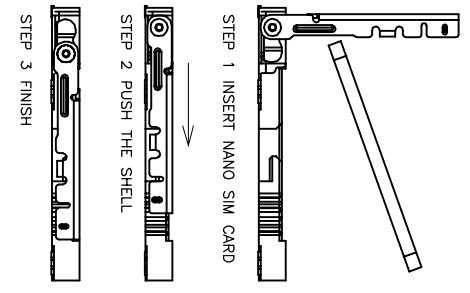

REV	ECN #	DESCRIPTION	DRAWING	APPROVED	DATE
A		NEW RELEASE	DEV1		6/11/15

- NOTES:
- ELECTRICAL SPECIFICATIONS:
 CURRENT RATING: 0.5A.
 VOLTAGE RATING: 5V.
 CONTACT RESISTANCE: 50 MILL.OHM MAX.
 INSULATION RESISTANCE: 1000 MEG.OHM MIN.
 - MECHANICAL SPECIFICATIONS:
 DURABILITY: 5000 CYCLES MIN.

料号编码

SM58-06 C B 03-00

- ① 产品系列: SM58: NANO CARD CONNECTOR
- ② 产品PIN数: 06: 6PIN
- ③ 塑胶材料: C: LCP
- ④ 塑胶颜色: B: 黑色
- ⑤ 产品流水号: 00: 1.5h

NO.	DESCRIPTION	MATERIAL	REMARKS	QTY
3	CONTACT	phosphor bronze CS210 T=0.12mm	Au/Ni Plated	1SET
2	HOUSING	High temperature plastic(LCP)	BLACK	1PCS
1	SHELL	SUS304 T=0.20mm	Au/Ni Plated	1PCS

CUSTOMER DRAWING
 YTCOMM
 http://www.hytc.com
 Dongguan YTCOMM Electronics Technology Co., Ltd

GENERAL TOLERANCE	DRAWING	DEV1	TITLE:
X ±0.20			NANO SIM卡座 1.5h
XX ±0.15	APPROVED		
XXX ±0.10			
ANGEL TOLERANCE	DATE	2016.11.03	DRAWING NO. C-SM58-00
X ±.3			
XX ±.2			
XXX ±.1			

UNIT	SCALE	SIZE	A4	SHEET	of 1	REV
mm	1:1	A4			1 of 1	A